

NOTES:

1. VISIT GRACECONSTRUCTION.COM FOR THE MOST CURRENT DETAILS AND INSTALLATION VIDEO
2. REFER TO PRODUCT DATA SHEETS ON WEBSITE FOR FURTHER INFORMATION
3. THE DRIP EDGE IS INSTALLED OVER THE GRACE ROOF DETAIL MEMBRANE
4. LAYER OF UNDERLAYMENT IS INSTALLED OVER THE DRIP EDGE
5. INTEGRATE GRACE ROOF DETAIL MEMBRANE AND UNDERLAYMENT TO FORM WATER-SHEDDING LAPS
6. REPAIR ALL HOLES LEFT FROM REMOVAL OF TOE BOARDS, ROOF JACKS, ETC.

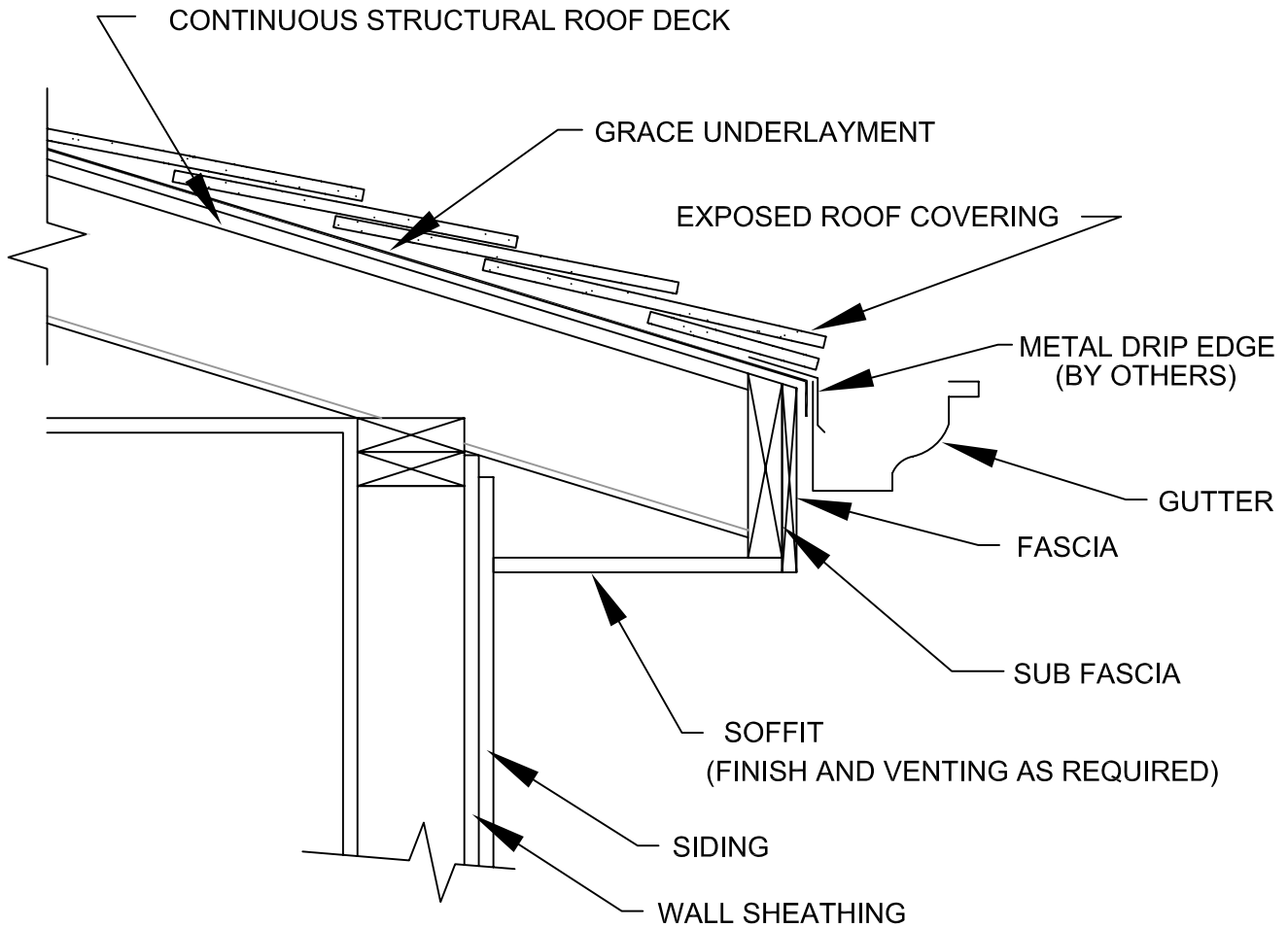

NOTES:

- A. VISIT GRACECONSTRUCTION.COM FOR THE MOST CURRENT DETAILS AND INSTALLATION VIDEO
- B. REFER TO PRODUCT DATA SHEETS ON WEB SITE FOR FURTHER INFORMATION
- C. THE DRIP EDGE IS INSTALLED OVER THE GRACE UNDERLAYMENT
- D. INSTALL GRACE UNDERLAYMENT TO FORM WATER-SHEDDING LAPS
- E. REPAIR ALL HOLES LEFT FROM REMOVAL OF TOE BOARDS, ROOF JACKS, ETC.

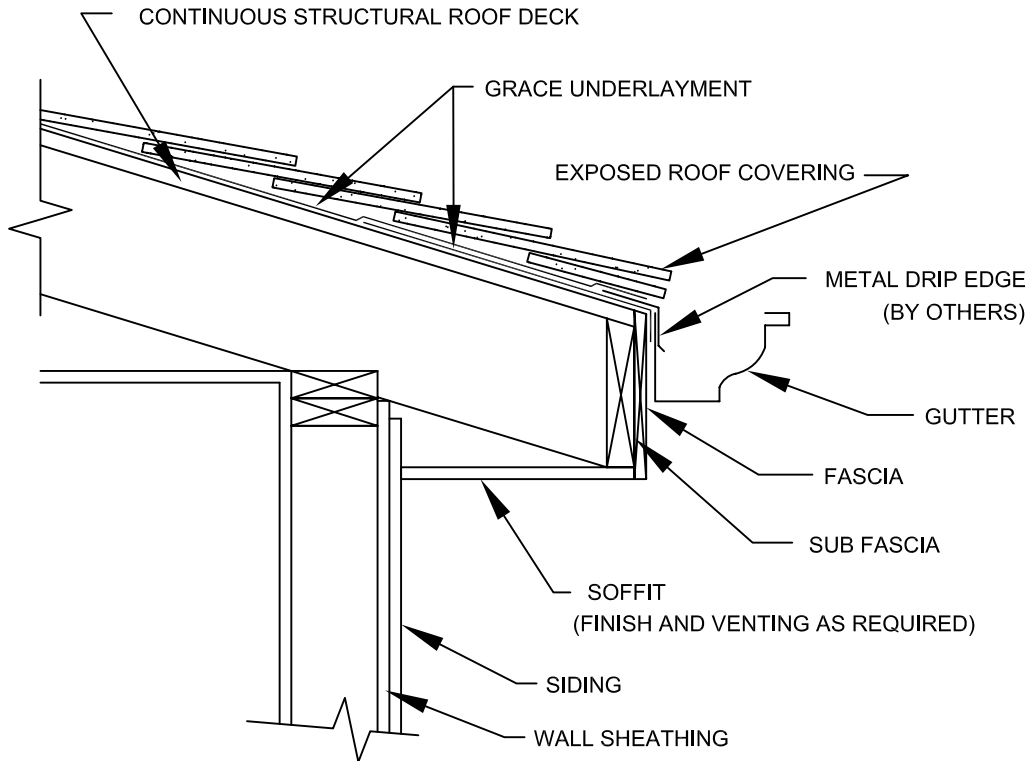

NOTES:

- A. VISIT GRACECONSTRUCTION.COM FOR THE MOST CURRENT DETAILS AND INSTALLATION VIDEO
- B. REFER TO PRODUCT DATA SHEETS ON WEB SITE FOR FURTHER INFORMATION
- C. THE DRIP EDGE IS INSTALLED OVER THE FIRST LAYER OF GRACE UNDERLAYMENT
- D. DO NOT INSTALL GRACE UNDERLAYMENT OVER CEDAR SHINGLES (REFER TO TECHNICAL LETTER #15)
- E. A SECOND LAYER OF GRACE UNDERLAYMENT IS INSTALLED OVER THE DRIP EDGE
- F. INSTALL GRACE UNDERLAYMENT TO FORM WATER-SHEDDING LAPS
- G. REPAIR ALL HOLES LEFT FROM REMOVAL OF TOE BOARDS, ROOF JACKS, ETC.